

Amphitrite water recreational activities center

Open all year, 3000 m², 4 small pools

- * 25m pool
- * Waving pool,
- * Outdoor/Indoor play pool linked
- * A padding pool, a 45m toboggan
- * Sauna – Hammam , Massage-jets, whirlpool, bubble bench, jacuzzi (3 €)

One entry per day and per person included in the fare Tél. 03 80 89 15 20



AREA MAP



CITY CAMPSITE LES TREILLES ***



Prices - Season 2021

Tel : + 33 (0)3 80 92 69 50

Email: camping.lestreilles@montbard.fr

Site : www.montbard.fr



Rue Michel Servet
21500 Montbard

TOURIST ATTRACTIONS

Montbard, Buffon city ,
not to be missed



A classified Buffon Museum, with :

- * Old Orangerie
- * Buffon grounds/garden
- * Aubespain Tower
- * Saint-Louis Tower
- * Buffon Mansion (Louis XV style)
- * Museum fine Arts



A highly touristic area, in the middle of Burgundy

Surroundings to be seen

- | | |
|---|---------------------------------------|
| * Fontenay Abbey
(World Heritage) | * MuséoParc Alésia |
| * Buffon Great Ironworks
(forges) | * Semur-en-Auxois
Medieval city |
| * Flavigny sur Ozerain
fortified village | * Bussy-Rabutin
Renaissance Castle |

THE CAMPSITE

Campsite on 2.5 ha tree-shaded

- * 78 equiped pitches (each 100 m²)
- * 2 High conveniences mobil-home lending and 19 mini-chalets
- * Volley, petanque, ping-pong, billiard table and foot table
- * Free tennis court
- * Children plays and summer animations
- * Summerhouse for picnic tables , barbecues places
- * Washing machine, drying cabinet, irons and ironing boards
- * Free block of ice freezer service
- * Baby room (changing table, bathtub)
- * baby bed and high chair for rent (depending on availibility)
- * T.V room, organised evenings in July and August
- * Draining service area, top up water for motor caravan
- * Fresh bread available
- * Shopping center at 1,3 km



Riding stable
Tél : 06 31 30 76 87

Water recreational activities center
One entry per day and per person included in the fare
Tél. 03 80 89 15 20



1 Mobil-home 4 persons, 34 m²
Dimensions : 8.5 m X 4m / Bedding : 4 + 2



Bedding 6 Persons
1 Double bed (140x190) – 1° room
2 single beds (70x190) – 2° room
A sofa bed ,
Tableware : 6 persons



1 Mobil-home 4 persons, 28 m²
Dimensions : 7,2 m X 4m / Bedding : 4 + 2

Bedding 6 Persons
1 double bed (140x190) – 1 room
4 single beds (70x190) – 1 room
A sofa bed, Tableware : 6 persons

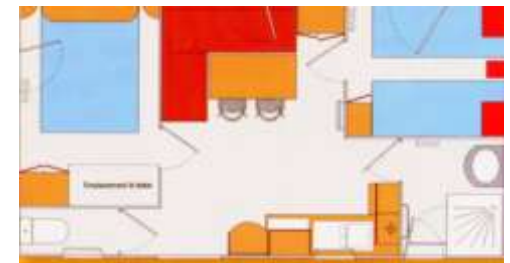

MOBIL-HOME



Equipment

Hob : 4 electric rings, Fridge/Freezer (215L), Dishwasher-microwave oven, Electric oven , Extractor fan, Electric water heater, Electric heater, Television, Lavatories, MEV (Continuous mechanical extract ventilation), in the bathroom and the kitchen , Rolling shutters, Rolläden.
Blankets and pillows available.

Half sheltered terrace outside with table and chairs

	Prices (roundings) Tourist tax in addition	<u>Very low season</u> 06/03-30/04 28/08-31/10	<u>Middle season</u> 01/05-09/07 21/08 - 27/08	<u>High season</u> 10/07 to 20/08
4 + 2	Per night	50 €	65 €	91 €
28m²	One week 7 nights (-25%)	262,50 €	341,25 €	477,75 €
4 + 2	Per night	56 €	73 €	102 €
34m² 	One week 7 nights (-25%)	294 €	383,25 €	535,50 €

Saturday to Saturday in high season. Minimum 2 nights the rest of the year

Short stays accepted in high season only at last minute. **From 3 to 6 nights : -15%**

Pet = 4 € (only one per mobil-home)

Disposable sheets = double bed 7 € ; single bed 4 €

Deposit : 25% of the amount of the booking to be joined when reserved (not refundable) Booking fees : 15 €

Tourist tax for each person and each night : 0,65 €

(Except for children less than 13 years old and disabled people)

Balance : the day you arrive

Method of payment : credit card or cash

Guarantee : 185 € on arriving (check) It will be given back to you at the end of your staying according to the inventory of the lending and cleanliness.

Otherwise, a set price for cleaning will be asked (70€).

Please kindly notice that we do not supply for sheets nor pillowcases.

RECEPTION : opening hours

Month	Morning	Afternoon
March (not Sunday)	10 h 00 – 12 h 00	17 h 00 – 18 h 30
April	10 h 00 – 12 h 00	17 h 00 – 18 h 30
May - June	10 h 00 – 12 h 00	16 h 00 – 19 h 00
July - August	10 h 00 – 12 h 00	16 h 00 – 19 h 30
September	10 h 00 – 12 h 00	16 h 00 – 19 h 00
October	10 h 00 – 12 h 00	17 h 00 – 18 h 30

Service - Prices per night	27/03 to 09/07 28/08 to 31/10	10/07 to 27/08
Each person (adult) (shower included)	4.70 €	6.00 €
Each adolescent (13 to 18 years old) shower included	3.70 €	5.50 €
Each child from 3 to 12 years old (shower included)	3.50 €	4.50 €
Each child less than 3 years old	Gratuit	
Visitor	Gratuit	1.00 €
Visitor shower	1.00 €	
Each pet	2,00 €	
Electric wire (16 amperes)	4,20 €	
Equipped pitch 100m ² / caravan pitch + car	5,70 €	
Tent pitch + car or motobike	4,70 €	
Tente pitch + bicycle	3,20 €	
Additional tent or car	0.90 €	1.90 €
Draining area, top up water (off staying)	3,50 €	
Guarded parking lot	4,00 €	
A year pitch lending	900,00 €	
Group 12 minimum (2 adults + electric wire)	17.00 €	//////////
ACSI card (2 adults + electric wire + 1 pet)	16.00 €	//////////
Stop accueil (2 adults + child under 7)	11.00 €	//////////
FFCC members	- 10 %	- 5 %
From the 7th night	- 20 %	- 10 %
Departure on the afternoon	4 €	5 €
Tourist tax for each person and for each night	0.65 €	
Booking fees	10,00 €	



MINI-CHALET (without sanitary facilities)

- * 19 mini chalets for 4 to 5 persons
- * Very comfortable toilet block.
- * Available to disabled people
- * Baby room with bathtub
- * Playground, ping-pong, petanque
- * Summerhouse/ pavilion for picnic tables, barbecue places
- * Leisure room with television, kitchen area with equipment

Inside the mini-chalets
 Kitchen area with :
 electric hob,, microwave oven, electric coffee maker, fridge.
 Blankets , pillows available and electric heater,

	PRICES MINI CHALET Tourist tax in addition	<u>Low season</u> 27/03-02/07 28/08-31/10	<u>Middle season</u> 03/07 -9/07 21/08 -27/08	<u>High season</u> 10/07 - 20/08
Isabelle 12m ²	Per night	35 €	46 €	66 €
4 pers.	One week 7 nights -30%	171,50 €	225,40 €	323,40 €
Mélèze 12m ²	Per night	38 €	48€	70 €
4 pers.	One week 7 nights -30%	186,20 €	235,20 €	343€
Olga 17m ²	Per night	39 €	51 €	77 €
5 pers.	One week 7 nights -30%	191,10 €	249,90 €	377,30 €
Epicéa 17m ²	Per night	44 €	54 €	79 €
4 pers.	One week 7 nights -30%	215,60 €	264,60 €	387,10 €
Just for a step	Accommodation 4 pers.	31 €	42 €	52 €

Saturday to Saturday in high season. Minimum 2 nights the rest of the year

Short stays accepted in high season only at last minute.

Pet = 4 € (only one per chalet)

Disposable sheets = double bed 7 € ; single bed 4 €

Deposit : 25 % of the amount of the booking to be joined when reserved (not refundable)
Balance : the day you arrive

Method of payment : credit card or cash

Tourist tax for each person and each night : 0,65€ Booking fees: 15 €

Guarantee : 100 € on arriving (check) It will be given back to you at the end of your staying according to the inventory of the lending and cleanliness.

Otherwise, a set price for cleaning will be asked (70 €).

Please kindly notice that we do not supply for sheets nor pillowcases.

MINI-CHALET (without sanitary facilities)

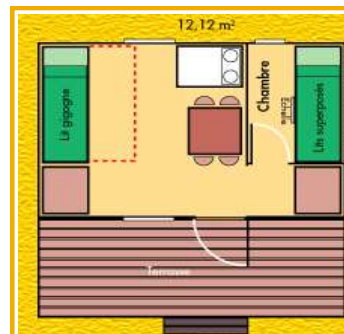

Isabelle Model (4 pers.)
12,12 m²

1 truckle bed (70+70cm)
2 bunk beds (70 cm)



Olga Model (5 pers.)
17,24 m²

2 truckle beds (70+70cm)
1 bed in height (70 cm)

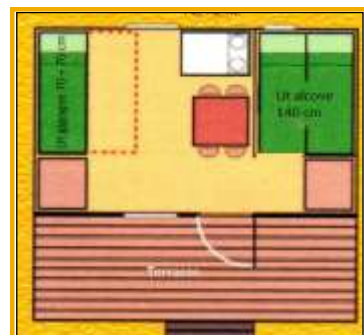
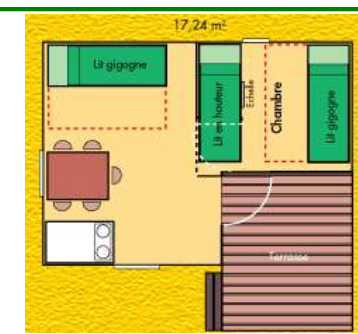

Mélèze Model (4 pers.)
12.12m²
Cabanature

1 truckle bed (70+70cm)
1 alcove bed 140 cm



Epicéa Model (4 pers.)
17.24 m²
Cabanature

1 truckle bed (70+70cm)
1 bed 140 cm

