

Amphitrite water recreational activities center

Open all year, 3000 m², 4 small pools

- * 25m pool
- * Waving pool,
- * Outdoor/Indoor play pool linked
- * A padding pool, a 45m toboggan
- * Sauna – Hammam , Massage-jets, whirlpool, bubble bench, jacuzzi

Free entry in the Amphitrite complex once a day from campsite

Tél. 03 80 89 15 20 www.carilis.fr



CITY CAMPSITE LES TREILLES ***



AREA MAP

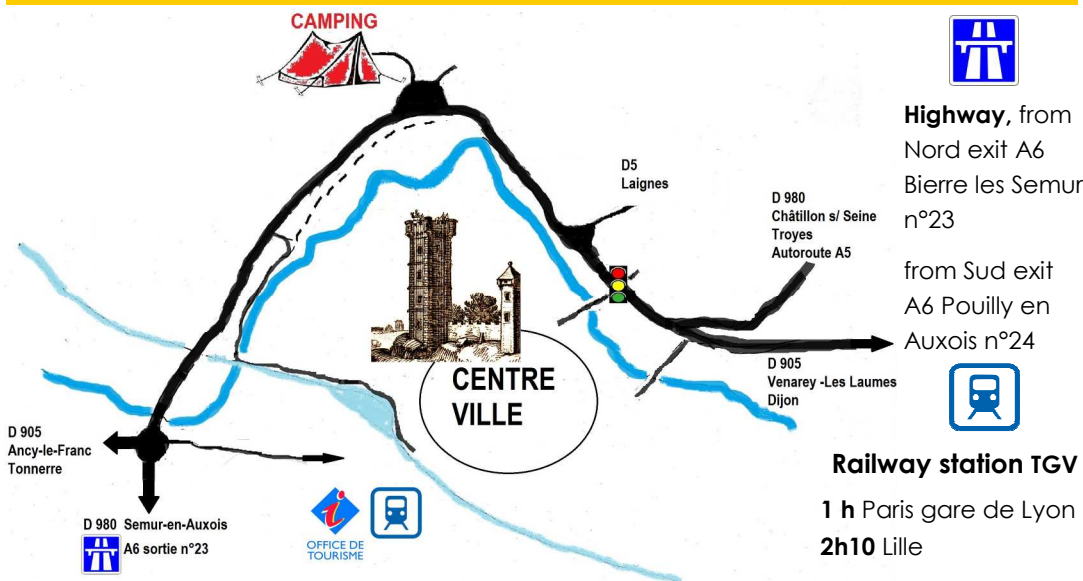

Prices 2017 Season

Tel : + 33 (0)3 80 92 69 50

Contact : camping.lestreilles@montbard.com

www.montbard.com

GPS : N 47°37'52" E 4°19'56"

Rue Michel Servet

21500 Montbard



TOURIST ATTRACTIONS

Montbard, Buffon city , not to be missed



A classified Buffon Museum, with :

- * Old Orangerie
- * Buffon grounds/garden
- * Aubespain Tower
- * Saint-Louis Tower
- * Buffon Mansion (Louis XV style)
- * Museum fine Arts



Ville Fleurie ***

A highly touristic area, in the middle of Burgundy

Surroundings to be seen

- | | |
|---|---------------------------------------|
| * Fontenay Abbey
(World Heritage) | * MuséoParc Alésia |
| * Buffon Great Ironworks
(forges) | * Semur-en-Auxois
Medieval city |
| * Flavigny sur Ozerain
fortified village | * Bussy-Rabutin
Renaissance Castle |

THE CAMPSITE

Campsite on 2.5 ha tree-shaded

- * 78 equiped pitches (each 100 m²)
- * 2 High conveniences mobil-home lending and 19 mini-chalets
- * Volley, petanque, ping-pong, billiard table and foot table
- * Free tennis court
- * Children plays and summer animations
- * Summerhouse for picnic tables , barbecues places
- * Washing machine, drying cabinet, irons and ironing boards
- * Free block of ice freezer service
- * Baby room (changing table, bathtub), baby bed and high chair lending (depending on availability)
- * T.V room, organised evenings in July and August
- * Draining service area, top up water for motor caravan
- * Fresh bread available
- * Shopping center at 1,3 km



Riding stable
Tél : 06 31 30 76 87

Water recreational activities center
Free entry in the Amphitrite complex
once a day from campsite
Tél. 03 80 89 15 20 www.carillis.fr



1 Mobil-home 4 persons, 34 m²

Dimensions : 8.5 m X 4m / Bedding : 4 + 2



Bedding 6 Persons

1 Double bed (140x190) – 1° room
2 single beds (70x190) – 2° room
A sofa bed ,
Tableware : 6 persons

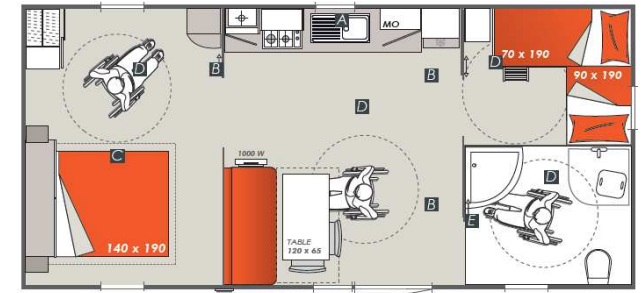

1 Mobil-home 4 persons, 28 m²

Dimensions : 7,2 m X 4m / Bedding : 4 + 2

Bedding 6 Persons

1 double bed (140x190) – 1 room
4 single beds (70x190) – 1 room
A sofa bed, Tableware : 6 persons

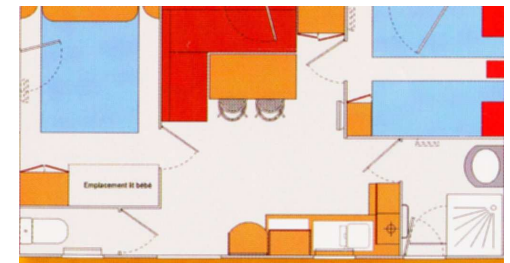

MOBIL-HOME



Equipment

Hob : 4 electric rings, Fridge/Freezer (215L), Dishwasher-microwave oven, Electric oven , Extractor fan, Electric water heater, Electric heater, Television, Lavatories, MEV (Continuous mechanical extract ventilation), in the bathroom and the kitchen , Rolling shutters, Rolläden. Blankets and pillows available.

Half sheltered terrace outside with table and chairs

	Prices 04/03 to 01/11/ 2017 (roundings) Tourist tax in addition	<u>Very low season</u> 04/03-01/04 26/08-01/11	<u>Middle season</u> 01/04-29/04	<u>Low season</u> 29/04 to 08/07	<u>High season</u> 08/07 to 26/08
4 + 2 28m ²	Per night	47 €	70.50 €	61.10 €	85.54 €
	One week 7 nights (-25%)	246,75 €	372.75 €	320.25 €	449.08 €
	Additional night	30 €	50 €	45 €	60 €
4 + 2 34m ² 	Per night	52.88 €	79.31 €	68.74 €	96.23 €
	One week 7 nights (-25%)	277.59 €	420.00 €	360.87 €	505.22 €
	Additional night	35 €	60 €	50 €	65 €

Saturday to Saturday in high season. Minimum 2 nights the rest of the year

Short stays accepted in high season only at last minute. **2/3 nights—10% ; 4 nights—20%**

Pet = 4 € (only one per mobil-home)

Disposable sheets = double bed 7 € ; single bed 4 €

Deposit : 25% of the amount of the booking to be joined when reserved (not refundable) **Booking fees** : 6 €

Tourist tax for each person and each night : 0,45€

(Except for children less than 13 years old and disabled people)

Balance : the day you arrive

Method of payment : credit card or cash

Guarantee : 185 € on arriving (check) It will be given back to you at the end of your staying according to the inventory of the lending and cleanliness.

Otherwise, a set price for cleaning will be asked (70€).

Please kindly notice that we do not supply for sheets nor pillowcases.

RECEPTION : opening hours / PRICES

Month	Morning	Afternoon
March (not Sunday)	10 h 00 – 12 h 00	17 h 00 – 18 h 30
April	10 h 00 – 12 h 00	17 h 00 – 18 h 30
May - June	10 h 00 – 12 h 00	16 h 00 – 19 h 00
July - August	10 h 00 – 12 h 00	16 h 00 – 19 h 30
September	10 h 00 – 12 h 00	16 h 00 – 19 h 00
October	10 h 00 – 12 h 00	17 h 00 – 18 h 30

Service - Prices per night	01/04 to 08/07	08/07 to 24/08
	24/08 to 01/11	24/08
Each person (adult) (shower included)	4.00 €	5,10 €
Each adolescent (13 to 18 years old) shower included	3.00 €	4,60 €
Each child from 3 to 12 years old (shower included)	3,00 €	3,60 €
Each child less than 3 years old	Gratuit	
Visitor	Gratuit	1.00 €
Visitor shower	1.00 €	
Each pet	1,00 €	2,00 €
Electric wire (16 amperes)	4,00 €	
Equipped pitch 100m ² / caravan pitch + car	5,10 €	
Tent pitch + car or motobike	4,10 €	
Tente pitch + bicycle	2,60 €	
Additional tent or car	Gratuit	1.50 €
Draining area, top up water (off staying)	3,10 €	
Guarded parking lot	3,00 €	
A year pitch lending	900,00 €	
Group 12 minimum (2 adults + electric wire)	15.00 €	////////
ACSI card (2 adults + electric wire + 1 pet)	15.00 €	////////
Stop accueil (2 adults + child under 7)	11.00 €	////////
FFCC members	- 10 %	- 5 %
From the 7th night	- 20 %	- 10 %
Tourist tax for each person and for each night	0.40 €	
Booking fees	4,00 €	



MINI-CHALET (without sanitary facilities)

- * 19 mini chalets for 4 to 5 persons
- * Very comfortable toilet block.
- * Available to disabled people
- * Baby room with bathtub
- * Playground, ping-pong, petanque
- * Summerhouse/ pavilion for picnic tables, barbecue places
- * Leisure room with television, kitchen area with equipment

Inside the mini-chalets

Kitchen area with :
 electric hob,
 microwave oven, electric
 coffee maker, fridge
 Blankets and pillows
 available

	TARIFS 2017 MINI CHALETS April 1th to November 01th Tourist tax in addition	<u>Low season</u> 01/04-08/07 26/08-01/11	<u>Middle season</u> 08 au 15/07 19 au 26/08	<u>High season</u> 15/07 au 19/08
Isabelle 12m²	Per night	32 €	42 €	61 €
4 pers.	One week 7 nights -30%	157 €	206 €	299 €
Mélèze 12m²	Per night	35 €	44 €	64 €
4 pers.	One week 7 nights -30%	172 €	216 €	314 €
Olga 17m²	Per night	36 €	47 €	71 €
5 pers.	One week 7 nights -30%	176 €	230 €	348 €
Epicéa 17m²	Per night	40 €	50 €	73 €
5 pers.	One week 7 nights -30%	196 €	245 €	358 €
Just for a step	Accomodation 4 pers.	28 €	38 €	48 €

Saturday to Saturday in high season. Minimum 2 nights the rest of the year

Short stays accepted in high season only at last minute.

2 nights—5 % ; 3/4 nights—10% ; 2 weeks—50%

Pet = 4 € (only one per chalet)

Disposable sheets = double bed 7 € ; single bed 4 €

Deposit : 25% of the amount of the booking to be joined when reserved (not refundable)

Balance : the day you arrive

Method of payment : credit card or cash

Tourist tax for each person and each night : 0,45€ Booking fees: 6€

Guarantee : 100 € on arriving (check) It will be given back to you at the end of your staying according to the inventory of the lending and cleanliness. Otherwise, a set price for cleaning will be asked (70€).

Please kindly notice that we do not supply for sheets nor pillowcases.



MINI-CHALET (without sanitary facilities)

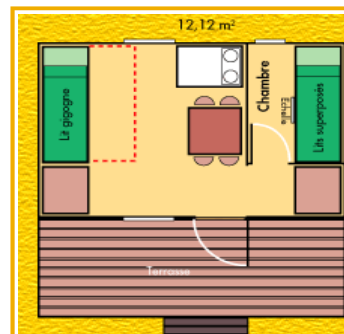

Isabelle Model:

12,12 m²

1 truckle bed
(70+70cm)
2 bunk beds (70 cm)



Olga Model:

17,24 m²

2 truckle beds
(70+70cm)
1 bed in height (70 cm)

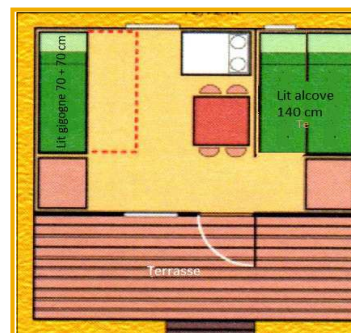
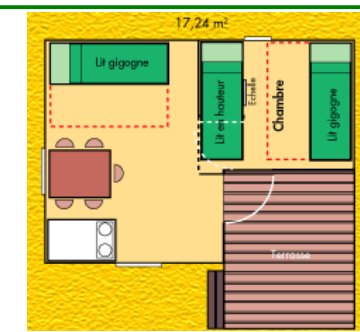

Mélèze Model :

12.12m²
Cabanature

1 truckle bed
(70+70cm)
1 alcove bed 140 cm



Epicéa Model :

17.24 m²
Cabanature

1 truckle bed
(70+70cm)
1 bed 140 cm

